

TF BASE HEATER - RETRO-FIT KIT TF-BHF (FRONT HEAT)

SpecTech, Inc. Base Heater includes a replacement *heavy-duty metal toe-space base* manufactured to accept the UL approved KT heater, and designed to carry the weight of a fully loaded cash handling pedestal. The base has also been pre-drilled with pilot holes for mounting to a number of the major cash handling pedestal suppliers. Do not attempt to modify the new (or factory provided base from the pedestal manufacturer) – doing so could compromise the structural integrity of the base and could cause damage or injury.

The KT heater carries its own manufacturers warranty – see warranty information enclosed in kit for service numbers.

KIT INCLUDES:

- (1) Retrofit Metal Base
- (1) UL approved, KT Compact Forced Air Heater with Thermostat.
- (1) 8' Electrical Cord & Plug
- (4) Leveling Feet
- (4) Mounting Machine Screws
- (1) Rubber Grommet

INSTALLATION INSTRUCTIONS:

1. Remove Factory Base (typically 4 machine screws from bottom of pedestal).
2. Position the TF Base Heater to match predrilled mounting screw holes and attach with machine screws.
3. Remove appropriate knockouts from the desired side to run out the electrical cord.
4. Place rubber grommet in hole and insert the electrical cord through.
5. Attach enclosed plug to cord (Note: refer to local code and hard wire if required).
6. Plug in cord and test Heater
7. Upon successful test, install pedestal per manufacturers specifications.

Overall Dims:

18.75" wide x 16.375 Deep x 4" High

Power requirements: 120vac 15amp circuit

500/1000 watt unit = 4amp / 8amp draw

750/1500 watt unit = 6amp / 12amp draw

Standard Color: Black, with black grill

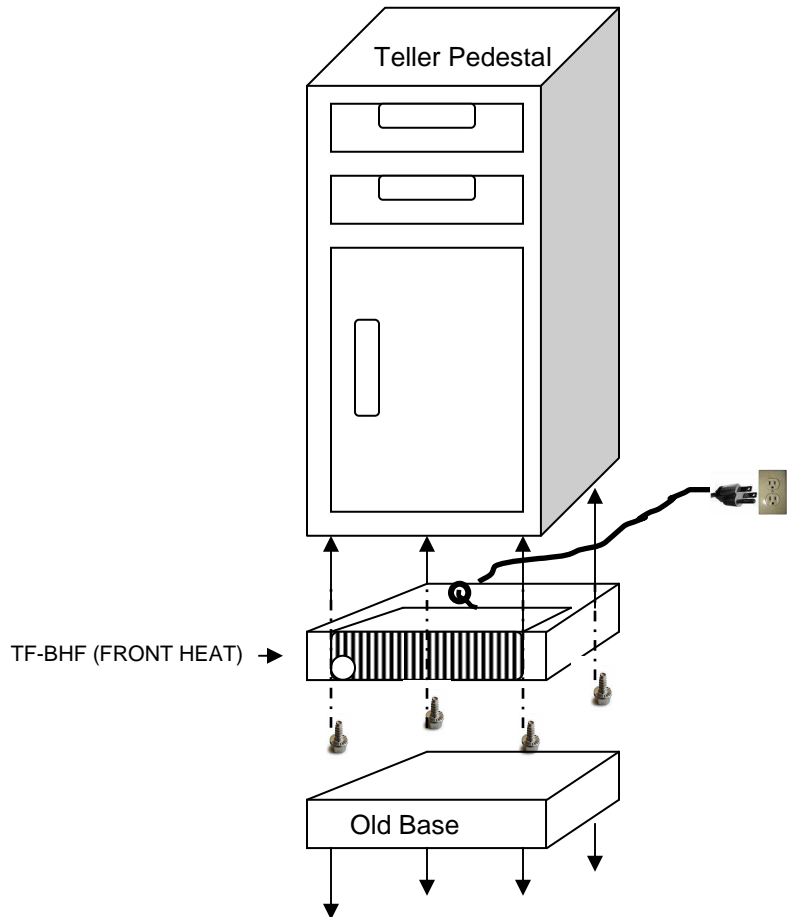

SpecTech, Inc.

"Creative Ideas For Practical Products"

Minneapolis, MN

P/ 952.932.0022 F/ 952.932.2942